



Saxon House

1 Parkland Walk, King's Road Park, SW6 2QG

£1,400,000



Floor Plan

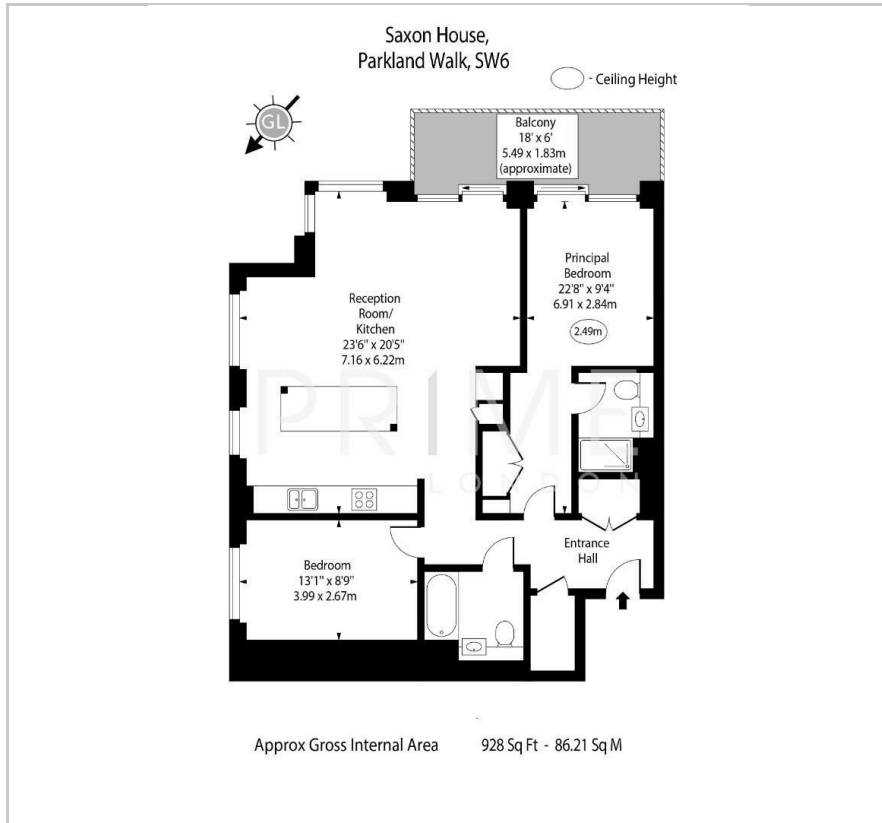

Area Map



Energy Efficiency Graph



Viewing

By appointment. Contact us on 0207 052 1075 if you wish to arrange a viewing appointment for this property, or require further information.

- Exceptional two bedroom ▪ 928 sq ft (86.21 sqm) apartment
- Open plan kitchen and ▪ Residents only gym, pool, spa and cinema reception room
- Private balcony ▪ 24 hour concierge

This exceptional two bedroom apartment, located in the prestigious King's Road Park development, is available for chain free sale through Prime London.

Totalling 928 sq ft (86.21 sqm), the property boasts a generous open plan layout featuring a kitchen island, with access to a generous private balcony. The master bedroom is modern and spacious, with a walk in wardrobe and a sleek ensuite. The property features a second bedroom, an additional family bathroom, and ample storage throughout.

The property is situated within the King's Road Park development, which offers its residents world class facilities including a private gym, pool, spa, cinema and 24 hour concierge.

Positioned just a short walk away from the prestigious area of Chelsea, the apartment has easy access to King Road's restaurants, cafes and shops.

For transport, Saxon House benefits from its proximity to Imperial Wharf and Fulham Broadway stations, offers excellent transport links.



These particulars, whilst believed to be accurate are set out as a general outline only for guidance and do not constitute any part of an offer or contract. Intending purchasers should not rely on them as statements of representation of fact, but must satisfy themselves by inspection or otherwise as to their accuracy. No person in this firm's employment has the authority to make or give any representation or warranty in respect of the property.